

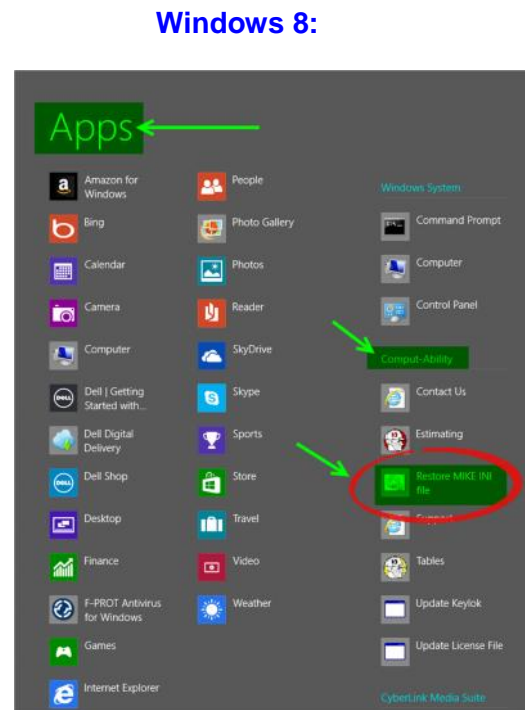

Fixing the “Error –Constant File Cannot Be Opened”

Fix 1) Microsoft Updates and computer crashes can damage program files. This is most likely what damaged MIKE's "Constant File." The program "Restore MIKE INI file" fixes this error **90%** of the time. After running this utility, launch MIKE again.

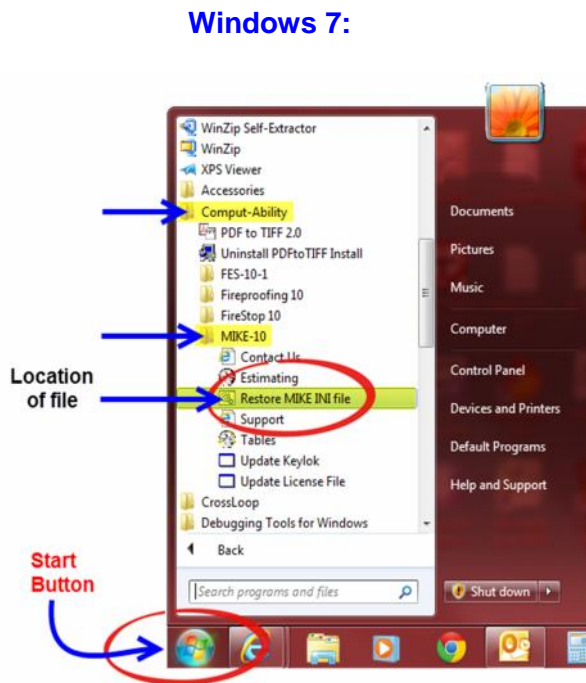

Fix 2) If you are still getting the error, you will need to follow these steps to completely reinstall MIKE. This will **not affect** your MIKE data. You will need to reconfigure MIKE, if your data is stored on a server.

Step 1. Delete the MIKE program folders, “MIKE” and “uniPass1x.” You will find these folders in the
C:\comput-ability folder.

Step 2. Then reinstall MIKE from this link. <http://www.comput-ability.net/support/MIKE10/MIKE10-1.exe>